

Series 102 200 Terminal Block

- ❑ Front Design PCB Terminal Block
- ❑ 22-14 AWG, 15 Amp, 300V
- ❑ Center to center pin spacing: .200"/5.08mm
- ❑ Optional pin spacing: .300"/7.62mm
- ❑ Wire and screw parallel
- ❑ UL, CSA approved and VDE rated
- ❑ Flammability Rating UL 94VO
- ❑ Number of Poles: 2-36 for .200"/5.08mm
- ❑ Number of Poles: 2-24 for .300"/7.62mm

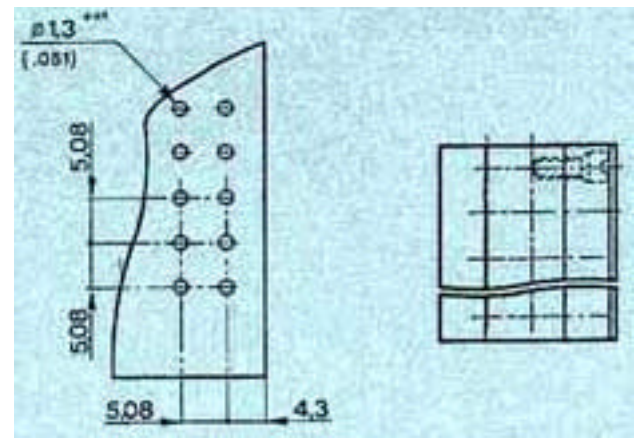
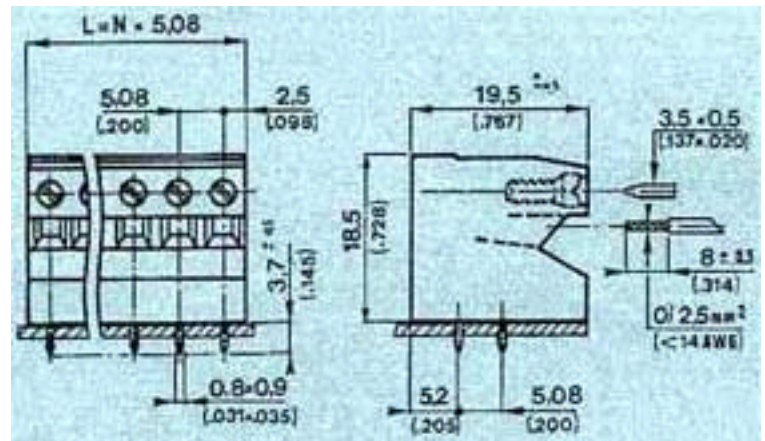

Dimensional Data

Center to Center Spacing (P)	.200" / 5.08mm
Number of positions (N)	2...18
Please consult us about positions (N)	19...36
Captive screws	Ø.118" / M3
Blade of screwdriver	.138" x .20" / 3.5mm x 0.5mm
Recommended tightening torque	5.22 lb./in. / 0.6 mN
Insulation stripping length	.315" ± .20" / 8mm ± 0.5mm
P.C.B. thickness	≤ .094" / ≤ 2.4mm

Technical Data

Pin (plating)	Brass (nickel / tin-lead)
Screw-clamp (plating)	Steel (zinc)
Housing	UL 94 V O grey polycarbonate
Operating temperature	-40°F + 258°F / - 40°C + 125°C
Insulation resistance	≥ 10 ¹² Ω

Electrical Characteristics

	UL	CSA	NFC-UTE	DIN-VDE
Wire range (solid or stranded)	22-14 AWG	22-14 AWG	2.5 mm 2	2.5mm 2
Maximum current rating (+ 68°F / + 20°C)	15A	15A	15A	15A
Operating voltage rating	V≈ 300	300	250 C cat.	250 C gr.
Dielectric withstand	V≈ 1600	1600	2500	2500
Flammability	94 V O			

Other Pin Spacing Options

103.200	Center to Center Spacing .300" / 7.62 mm
---------	--